

**CUSTOMER SERVICE**  
CARDIN ELETTRONICA

**SERIES SL - AUTOMATION FOR SLIDING GATES**

101/SL424E9-101/SL424E9CB-100/SL524-100/SL524CB

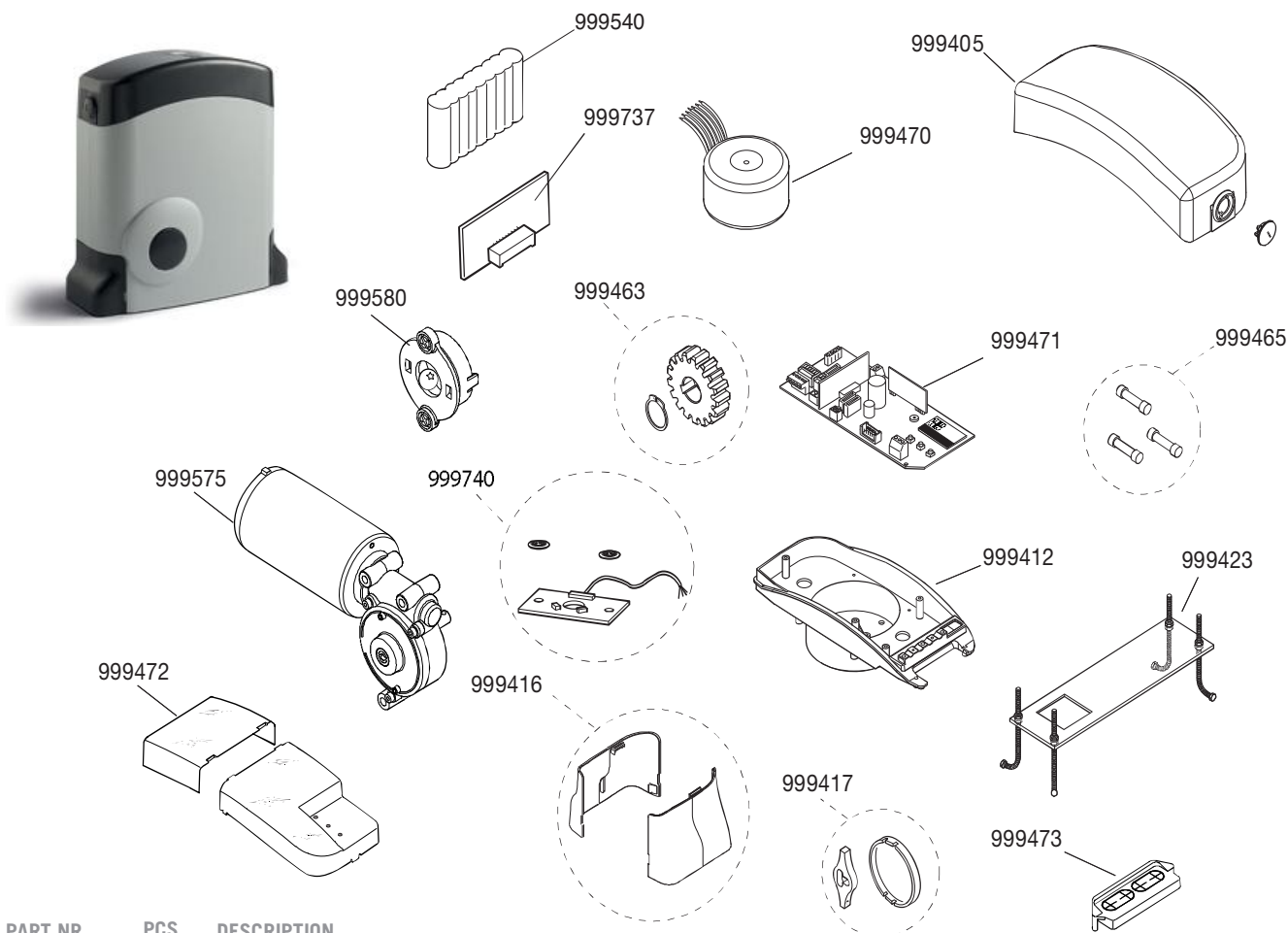

PART NR.	PCS	DESCRIPTION
999405	1	Upper cover
999412	1	Electronic card support well
999540	1	Battery NiMH 1300 mAh-24V
999416	1	Side covers
999417	1	Manual release mechanism key + cover
999423	1	Motor base plate in metal
999463	1	Pinion
999465	1	Set of 20 fuses 1,6A - 3,15A - 10A
999470	1	Transformer ZUT135VA
999471	1	Electronic card for SL424/SL524
999472	1	Transparent electronic card cover
999473	1	Cable clamp
999575	1	Motor unit + Hall sensor
999580	1	Manual release unit
999737	1	Battery charger
999740	1	Encoder