



CARDIN ELETTRONICA spa

Via del lavoro, 73 – Z.I. Cimavilla 31013 Codognè (TV) Italy

Tel: +39/0438.404011

Fax: +39/0438.401831

email (Italy): Sales.office.it@cardin.it

email (Europe): Sales.office@cardin.it

Http: www.cardin.it

SERIAL NUMBER	SERIES	MODEL	DATE
ZVL657.01	CDR	REFLEX	04.06.2019
This product has been tried and tested in the manufacturer's laboratory, during the installation of the product follow the supplied indications carefully.			

REFLEXIÓS INFRASOROMPÓ

REMARKS

These instructions are aimed at professionally qualified "installers of electrical equipment" and must respect the local standards and regulations in force. The use and installation of these appliances must rigorously respect the indications supplied by the manufacturer and the safety standards and regulations in force.



Attention! Only for EU customers - WEEE marking.

This symbol indicates that once the products life-span has expired it must be disposed of separately from other rubbish.

The user is therefore obliged to either take the product to a suitable differential collection site for electronic and electrical goods or to send it back to the manufacturer if the intention is to replace it with a new equivalent version of the same product.

Suitable differential collection, environmental friendly treatment and disposal contributes to avoiding negative effects on the ambient and consequently health as well as favouring the recycling of materials. Illicitly disposing of this product by the owner is punishable by law and will be dealt with according to the laws and standards of the individual member nation.

DESCRIPTION

CDR REFLEX is system made up of a one photoelectric unit with an inbuilt transmitter and receiver and a passive retro-reflector disc. Self locking adjustable lens which can be rotated horizontally and vertically through plus or minus 10° with respect to the standard installation position. These adjustments permit lateral fitting and installations where the photoelectric cell and retro-reflector disc are at different heights. (see details b and c, fig. 2)

USE

The infrared barrier constitutes an efficient safety system for the protection of passageways or spaces which are equipped with automatic door or gate systems. It is suitable for systems which have a passing room of not more than 10m.

TECHNICAL SPECIFICATIONS

- Emission with continuous modulation at **6,75 KHz**.
- Infrared emission wavelength: **623 nm**.
- Power supply: **12 - 24Vac/dc**.
- Maximum commutable power of relay with resistive load: **28W in dc/60VA in ac** - Max. voltage **40V ac/dc**
- Power consumption:
12V ac/dc, 21 mA
24V ac/dc, 36 mA
- Operating temperature: **-10...+55°C**.
- Adjustable lens on self lubricating and self locking ball joint.
- Selection of the relay output contact mode N.C.-N.O. or 8,2kΩ via jumpers.
- Led signal strength indicator facilitates lens centring.

Test function:

- When wired to a suitable electronic programmer, this function allows the continuous control of the presence of the infrared signal thus increasing the safety and security level of the installation.
- Protection grade **IP55**.
- Range: **10m** under all weather conditions such as thick fog, rain, dust etc.

INSTALLATION

Note: In the case of installations involving more than one device, it is necessary to leave a minimum distance of 1 metre between each device (see part C of fig. 2).The photoelectric cell and reflector disc are normally positioned frontally on the same geometrical axis and at the same height from the ground.

Photocell installation (fig. 3)

- Installation is possible on all types of structure. Other than the standard aligned positioning the device can also be positioned both laterally (moving the device out of the passageway) and at different heights in order to solve problems posed by different structures (detail a-b-c fig. 2).
- Choose the points at which the devices are to be surface mounted,

according to the requirements of the system.

- Work out the run of the cables from the structure to the point of connection.
- Fix the fast-fitting bracket at the chosen point (detail 1).
- Pass the connecting cables through the hole in the base of the case.
- Move the p.c.b. card slightly then wire up and connect the cables.
- Once the device has been wired up, snap the case to the fast-fitting bracket, remembering to place the waterproof seal between the case and the bracket. The joint between the case and the bracket is guaranteed to be waterproof (detail 2).
- Insert the sealing gasket into its seat on the case, carry out any eventual adjustments and then fit the glass enclosing cover into place (details 5-6).

Installation of reflector disc (fig. 5)

- Choose the surface fixing point according to the requirements of the system.
- Remove screw "1" and nut "2" and remove disc "3".
- Insert nut "4" into the hole provided and secure it with a strip of adhesive tape "5".
- Mark the fixing points "6", drill a hole in the wall "7" and insert the wall plugs "8".
- Fix the protection base of the reflector disc to the wall using the two screws "10".
- Position the reflector disc "11" and secure it with the screw "12"

BEÁLLÍTÁS

Fotocella teszt bemenet

A TST vezérlő bemenet egy elszigetelt bemenet, ami leállítja az adót a vezérlés fotocella teszt funkciójához. Ha a TST bemenetre adott feszültség magasabb mint **10Vac/dc**, a bemenet magas jelszintű. Amennyiben alacsonyabb mint **6Vac/dc**, a bemenet alacsony jelszintű. A bemenetre adott feszültség lehet eltérő a fotocella tápfeszültségétől, de nem lehet magasabb mint **24Vac/dc**.

A **J3** (1-es ábra) jumper adja meg, hogy alacsony vagy magas bemenetre álljon le az adó. Ha 1-es bozicióban van, az adó működik, amíg a TST bemenet alacsony, leáll, ha a TST bemenet magas. **Ha a TST bemenet nincs használatban, állítsa a J3-at 1-es pozícióba.**

Bekötések, beállítások

- Húzza ki a panelt a 3-as ábra szerint.
- Állítsa be a J1 és J4 jumpereket a kívántnak megfelelően.
- Készítse el a bekötéseket az 1-es ábra szerint használjon legalább **0.2 mm² (AWG #24)** vezetékeket.
- Tegye vissza a panelt a helyére.
- Kapcsolja be az eszközt, ellenőrizze, hogy a piros led világít.

Sugár beállítás

A beállítás az optika és a tükör segítségével történik, elérve a lehető legmagasabb jelszintet. Ellenőrizze az L1 led által adott jelzést, érje el legalább a "Megfelelő" jelszintet. A jelszint visszajelzése az alábbiak szerint történik.

Státusz LED L1	Jelszint
Folyamatosan világít	Jó
Lassan villog	Megfelelő
Gyorsan villog	Alacsony
Nem világít, nem villog	Nincs bejövő jel

A J4 jumper az adó és a prizma közti távolságnak megfelelően kell beállítani. Ha a távolság kevesebb mint 5m, a J4-et 2-es pozícióba kell tenni. Ha a sugár beállításnál nem ér el megfelelő jelszintet, állítsa 1-es pozícióba. 5m-nél nagyobb távolság esetén állítsa 1-es pozícióba. Ellenőrizze, hogy a jelszint beállítás akkor is megfelelő, ha a fedél a helyére van téve.

CDR REFLEX



Bekötések

1

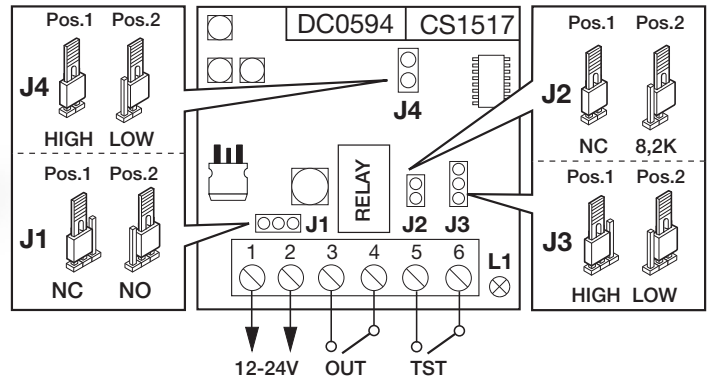

TST	Eszköz teszt bemenet	Device test input	Entrée de test de l'appareil	Gerätstest-Eingang	Entrada aparato de prueba
L1	Visszajelző led	Indicator led	Led de signalisation	Signal-Led	Led de señalización
J1	NC / NO kontakt kiválasztás	NC / NO contact selection	Sélection du contact NF / NO	Kontakt-Auswahl NC / NO	Selección contacto NC / NA
J2	Kontaktus / 8,2K ohm kimenet	Potential free / 8,2K selection	Sélection du contact sec / 8,2K	Kontakt-Auswahl potentialfrei / 8,2K	Selección sin contacto / 8,2K
J3	Teszt bemenet magas/alacsony	Safety device test low / high	Test sécurités haut / bas	Sicherheitstest hoch / niedrig	Prueba de seguridad alta / baja
J4	Hatótávolság magas/alacsony	range selection high / low	Sélection portée haut / bas	Reichweite-Auswahl hoch / niedrig	Selezione portata alta / baja
OUT	Relé kimenet	Relay output	Sortie relais	Relaisausgang	Salida relé

Telepítési példák

2

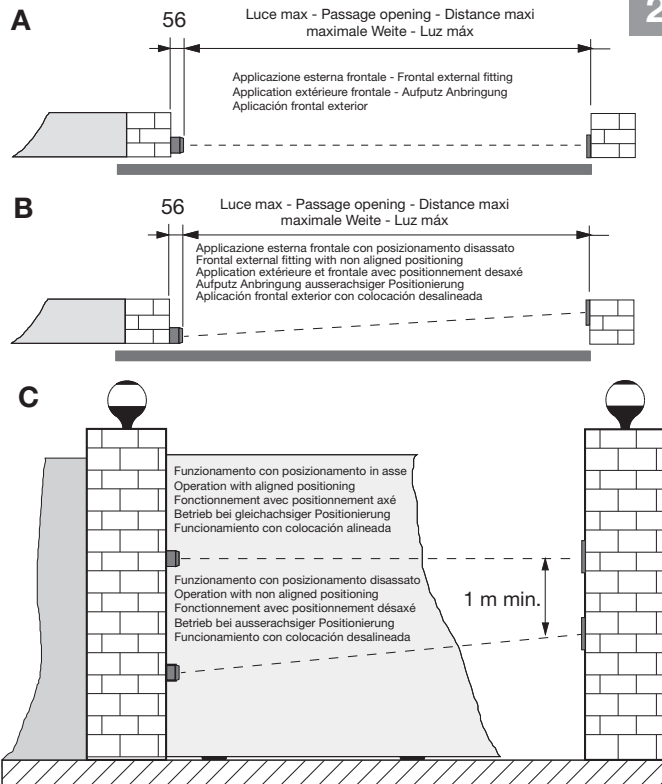

Infrasorompó részei, méretei

3

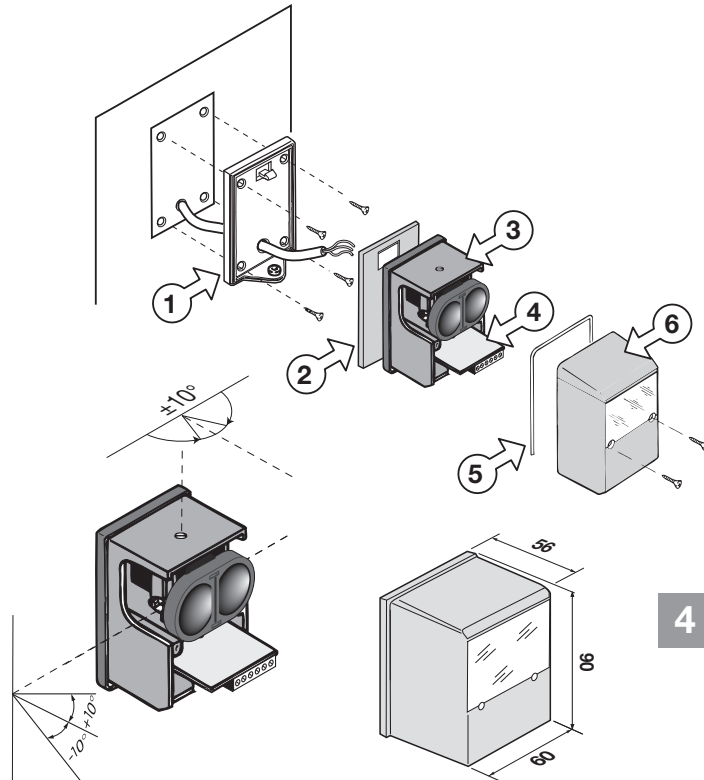

4

Prizma részei és felszerelése

5

