

SERIES GL - AUTOMATION FOR COUNTERBALANCED GARAGE DOORS
310/GLB249M - 310/GLB249S

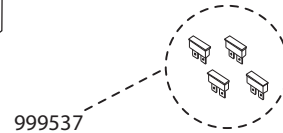
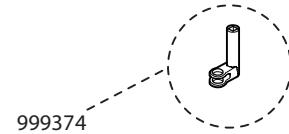
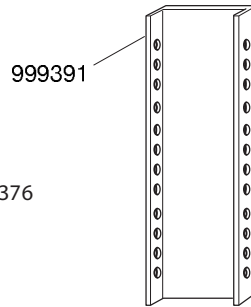
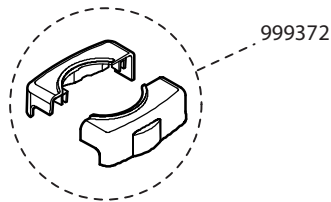
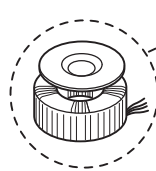
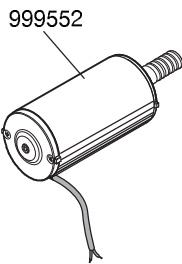
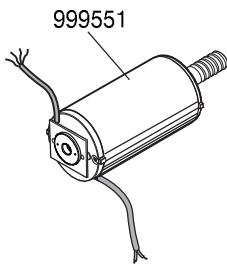
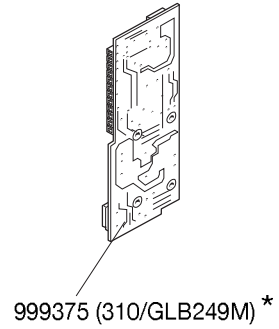
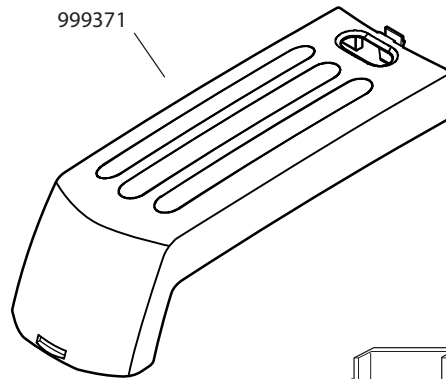

* To order the Electronic card you must indicate the circuit number printed on the back off the card, as well as the product code e.g.:

product code **999375 / 0000A** circuit code

PART NR.	PCS	DESCRIPTION
999371	1	Opaque cover
999372	1	Protective covers left/right
999374	1	Release mechanism lever
999375	1	Electronic card for GLB249M
999376	1	Transformer ZUT180VA.01GL
999391	1	Motor support plate 600 mm
999537	1	Set of 20 fuses 4A - 10A
999551	1	Motor + encoder (GLB249M)
999552	1	Motor (GLB249S)