

CUSTOMER SERVICE
CARDIN ELETTRONICA

SERIES GL - CHAIN-GUIDED AUTOMATION FOR SECTIONAL AND FOLD-UP GARAGE DOORS
311/GL1124

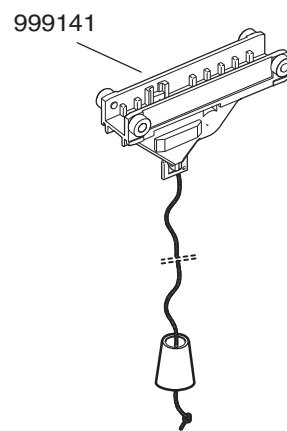
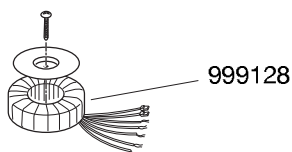
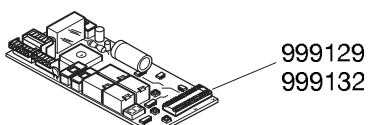
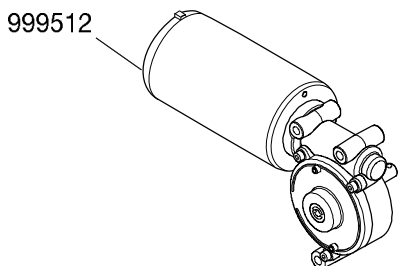
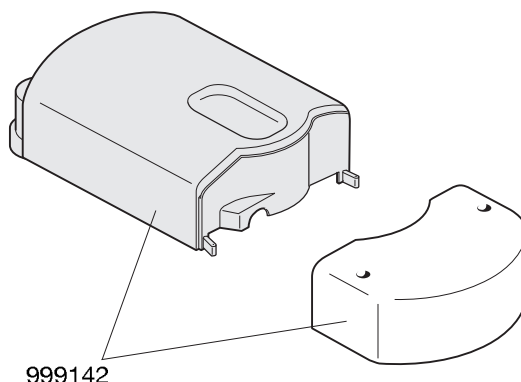

* To order the Electronic card you must indicate the circuit number printed on the back off the card, as well as the product code e.g.:

product code **999129 / 0000A** circuit code

| PART NR. | PCS | DESCRIPTION |
|----------|-----|------------------------------|
| 999128 | 1 | Transformer ZUT130VA 02 |
| 999129 | 1 | Electronic card for GL112409 |
| 999132 | 1 | Electronic card for GL112401 |
| 999141 | 1 | Carriage |
| 999142 | 1 | Protective case |
| 999512 | 1 | Motor unit |